

T:1.6 Dimension of PC board holes
Tolerance : ±0.1 (Printed-bottom View)

A Dimension : EARTH FITTING 4±0.4 ,CENTER CONTACT 3.7±0.4
B Dimension : EARTH FITTING 4.4±0.4 ,CENTER CONTACT 4.2±0.4

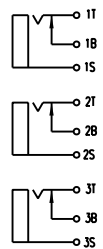
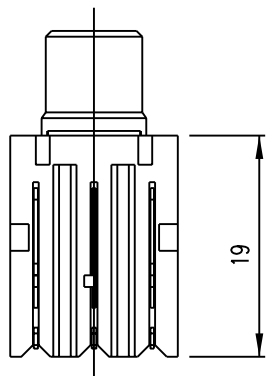

Circuit

| | | | | | | | | |
|----|---------------|---|-------|-------|---------|---------|-------|--------|
| 12 | TIP SPRING | 1 | C5212 | Ø0.35 | (1T) | MB:Cu | AG | PLATED |
| 11 | TIP SPRING | 1 | C5212 | Ø0.35 | (2T) | MB:Cu | AG | PLATED |
| 10 | TIP SPRING | 1 | C5212 | Ø0.35 | (3T) | MB:Cu | AG | PLATED |
| 9 | SHUNT SPRING | 1 | C2680 | Ø0.4 | (1B) | MB:Cu | AG | PLATED |
| 8 | SHUNT SPRING | 1 | C2680 | Ø0.3 | (2B) | MB:Cu | AG | PLATED |
| 7 | SHUNT SPRING | 1 | C2680 | Ø0.3 | (3B) | MB:Cu | AG | PLATED |
| 6 | EARTH FITTING | 1 | C2680 | Ø0.3 | (1S) | MB:Cu | Sn/Pb | PLATED |
| 5 | EARTH FITTING | 1 | C2680 | Ø0.3 | (2S) | MB:Cu | Sn/Pb | PLATED |
| 4 | EARTH FITTING | 1 | C2680 | Ø0.3 | (3S) | MB:Cu | Sn/Pb | PLATED |
| 3 | OUTER CONTACT | 3 | C2680 | Ø0.3 | | MB:Cu | Ni | PLATED |
| 2 | WASHER | 3 | ABS | | | UL-94HB | | |
| 1 | HOUSING | 1 | ABS | | (BLACK) | UL-94HB | | |

| LTR | PART NAME | QTY | MATERIAL(THICK,COLOR) | REMARK |
|------|-----------|------|-----------------------|--------------------------|
| DSND | | DATE | SCALE 2 / 1 | NAME PIN JACK |
| DWN | | DATE | 3RD ANGLE PROJECTION | CAT. NO. HSP-263AB- ____ |
| CHKD | | DATE | UNIT: mm | |
| APVD | | DATE | | |

SINGATRON (USA)

DWN.NO. A-263AB

001

UNLESS OTHERWISE SPECIFIED, TOLERANCE ON DECIMAL: ±0.3 FRACTIONS:

ANGLES: