

# DPM SERIES

## DUAL-PORT MACHINED PIN 9/9, 15/15, 25/25, 37/37, 50/50

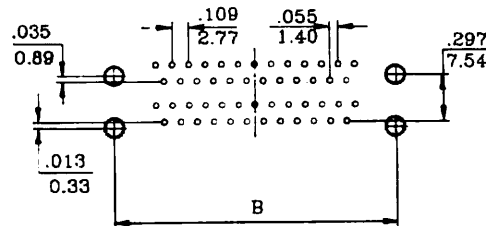
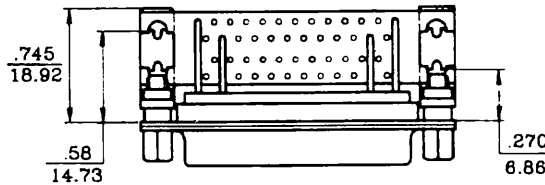
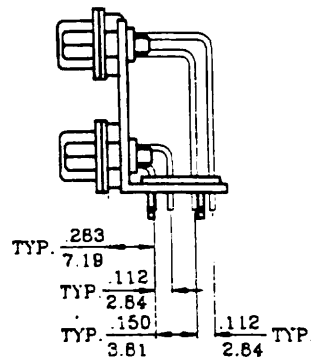
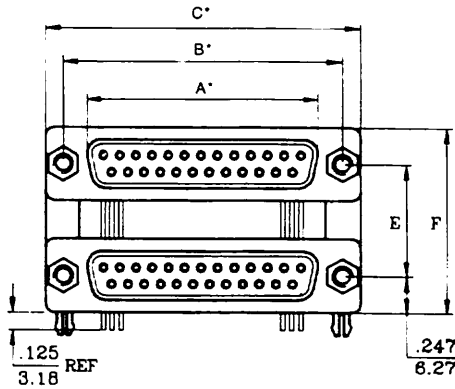
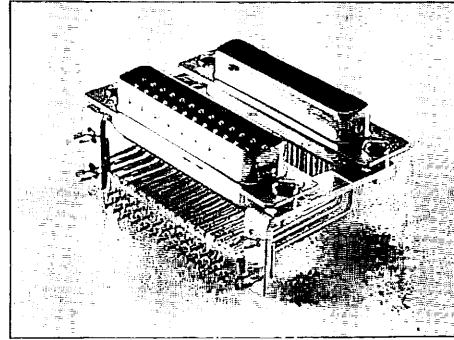

### DIMENSIONS

SHELL SIZE	A* .010 0.25	B* .005 0.13	C* .015 0.38
9 (E)	0.643 16.33	0.984 24.99	1.213 30.81
15 (A)	0.971 24.66	1.312 33.32	1.541 39.14
25 (B)	1.511 38.38	1.852 47.04	2.088 53.04
37 (C)	2.159 54.84	2.500 63.50	2.729 69.32
50 (D)	2.064 52.43	2.406 61.11	2.635 66.93

### DIMENSIONS

VERTICAL DIMENSION BETWEEN CONNECTORS	E 0.010 0.25	F 0.015 0.38
A	0.75 19.05	1.244 31.60
B	0.90 22.86	1.394 35.41
C	0.625 15.88	1.119 28.42

• MOUNTING OPTIONS:  
SEE PAGE 13

# MOUNTING OPTION



**OPTION O**  
FOUR .125 DIAMETER  
NON-THREADED  
MOUNTING HOLES



**OPTION K**  
FOUR THREADED (4-40)  
MOUNTING HOLES



**OPTION N**  
FOUR GROUNDING BRACKETS  
(LOCKING TYPE)

MOUNTING OPTIONS	DESCRIPTION
AO	0.750" SPACING, WITH FOUR .125 DIAMETER NON-THREADED MOUNTING HOLES
AOJ	0.750" SPACING, WITH FOUR .125 DIAMETER NON-THREADED MOUNTING HOLES, AND WITH FOUR JACK SCREWS ASSEMBLED TO CONNECTOR
AK	0.750" SPACING, WITH FOUR THREADED (4-40) MOUNTING HOLES
AKJ	0.750" SPACING, WITH FOUR THREADED (4-40) MOUNTING HOLES, AND WITH FOUR JACK SCREWS ASSEMBLED TO CONNECTORS
AN	0.750" SPACING, WITH FOUR GROUNDING BRACKETS (LOCKING TYPE)
ANJ	0.750" SPACING, WITH FOUR GROUNDING BRACKETS (LOCKING TYPE), AND WITH FOUR JACK SCREWS ASSEMBLED TO CONNECTORS
BO	0.900" SPACING, WITH FOUR .125 DIAMETER NON-THREADED MOUNTING HOLES
BOJ	0.900" SPACING, WITH FOUR .125 DIAMETER NON-THREADED MOUNTING HOLES, AND WITH FOUR JACK SCREWS ASSEMBLED TO CONNECTORS
BK	0.900" SPACING, WITH FOUR THREADED (4-40) MOUNTING HOLES
BKJ	0.900" SPACING, WITH FOUR THREADED (4-40) MOUNTING HOLES, AND WITH FOUR JACK SCREWS ASSEMBLED TO CONNECTORS
BN	0.900" SPACING, WITH FOUR GROUNDING BRACKETS (LOCKING TYPE)
BNJ	0.900" SPACING, WITH FOUR GROUNDING BRACKETS (LOCKING TYPE), AND WITH FOUR JACK SCREWS ASSEMBLED TO CONNECTORS
CO	0.625" SPACING, WITH FOUR .125 DIAMETER NON-THREADED MOUNTING HOLES
COJ	0.625" SPACING, WITH FOUR .125 DIAMETER NON-THREADED MOUNTING HOLES, AND WITH FOUR JACK SCREWS ASSEMBLED TO CONNECTORS
CK	0.625" SPACING, WITH FOUR THREADED (4-40) MOUNTING HOLES
CKJ	0.625" SPACING, WITH FOUR THREADED (4-40) MOUNTING HOLES, AND WITH FOUR JACK SCREWS ASSEMBLED TO CONNECTORS
CN	0.625" SPACING, WITH FOUR GROUNDING BRACKETS (LOCKING TYPE)
CNJ	0.625" SPACING, WITH FOUR GROUNDING BRACKETS (LOCKING TYPE), AND WITH FOUR JACK SCREWS ASSEMBLED TO CONNECTORS

# HOW TO ORDER

$\frac{DR}{1} - \frac{A}{2} \frac{15}{3} \frac{S}{4} - \frac{NJ}{5} - \frac{0}{6} \frac{0}{7} \frac{0}{8} - \frac{C}{9}$

$\frac{DP}{1} - \frac{E}{2} \frac{9}{3} \frac{S}{4} / \frac{E}{2} \frac{15}{3} \frac{S}{4} - \frac{ANJ}{5} - \frac{0}{6} \frac{0}{7} \frac{0}{8} - \frac{C}{9}$  (DUAL PORT ONLY)

TOP CONNECTOR      BOTTOM CONNECTOR

## 1. SERIES

## 2. SHELL SIZE

E - - - - -	9	B - - - - -	25
A - - - - -	15	C - - - - -	37
G - - - - -	19	D - - - - -	50
F - - - - -	23		

## 3. NO. OF CONTACTS

9, 15, 19, 23, 25, 26, 37, 44, 50, 62, 78, 104

## 4. CONTACT TYPE

P : PIN CONTACT (PLUG), BRASS  
S : SOCKET CONTACT (RECEPTACLE), PHOSPHOR BRONZE  
SB : SOCKET CONTACT (RECEPTACLE), BRASS

## 5. MOUNTING OPTIONS

## 6. CONTACT FINISH

0: GOLD FLASH	4: 15 $\mu''$
1: SELECTIVE GOLD FLASH	5: 20 $\mu''$
2: 5 $\mu''$	6: 30 $\mu''$
3: 10 $\mu''$	

## 7. INSULATOR COLOR

0: BLACK	2: BLUE
1: WHITE	3: GREY

## 8. SHELL PLATED

0: TIN	2: ZINC
1: NICKEL	3: ALL PLASTIC

## 9. CUSTOMER'S DESIGN

---

## FEATURES

- MEETS EIA, RS232C AND RS449 STANDARDS FOR DATA COMMUNICATION INPUT/OUTPUT CONNECTORS
- BRIGHT TIN SHELLS FOR EXCEPTIONAL CONDUCTIVITY AND GROUNDING
- INDENTATIONS (DIMPLES) FOR EXCEPTIONAL GROUNDING AND MATING RETENTION
- D SHAPE CONNECTOR MATING AND POLARIZATION
- SEVEN (7) SHELL SIZES
- FIVE (5) TYPES OF CONTACT TERMINATION, SOLDER CUP, SOLDER DIP, CRIMP, IDC AND RIGHT ANGLE
- TWO (2) TYPES OF CONTACT CONSTRUCTION, PRECISION MACHINED OR PRECISION FORMED
- ACCESSORIES ARE AVAILABLE

## PERFORMANCE SPECIFICATIONS

### MATERIALS AND FINISH

#### SHELL

STEEL MATERIAL, TIN FINISH AND IDENTIFICATIONS (DIMPLES) ON PLUG ONLY

#### INSERT

PBT THERMO PLASTIC, BLACK COLOR, 30% GLASS FILLED SELF EXTINGUISHING, 94V-0 RATED

#### CONTACT MATERIAL

PIN : BRASS  
SOCKET: PHOSPHOR BRONZE OR BRASS

### MECHANICAL CHARACTERISTICS

#### CONTACT RETENTION

PRECISION MACHINED CONTACT 10 LBS  
PRECISION FORMED CONTACT 10 LBS

#### CONTACT SEPARATION FORCE

4 OUNCES MIN

### ELECTRICAL CHARACTERISTICS

#### CONTACT CURRENT RATING

PRECISION MACHINED CONTACT 7.6 AMPS (WITH 20 AWG WIRE)  
PRECISION FORMED CONTACT 5.0 AMPS (WITH 20 AWG WIRE)

#### CONTACT RESISTANCE

PRECISION MACHINED CONTACT  
5 MILLIOHMS MAX  
PRECISION FORMED CONTACT  
8 MILLIOHMS MAX

### MILITARY AND FEDERAL SPECIFICATIONS

ASTM-B633	ZINC PLATING
QQ-B750	PHOSPHOR BRONZE
QQ-N-290	NICKEL PLATING
QQ-S-698	STEEL

#### CONTACT FINISH

GOLD FLASH OVER 100 MICRO INCH  
NICKEL ON ENTIRE CONTACT AREA.

#### GROUNDING BRACKET

BRASS MATERIAL, TIN FINISH

#### RIVETED INSERT

BRASS MATERIAL, NICKEL FINISH

#### JACK SCREW

BRASS MATERIAL,

#### CONTACT ENGAGEMENT FORCE

9 OUNCES MAX

#### DIELECTRIC WITHSTANDING VOLTAGE

1000 VAC MIN

#### INSULATION RESISTANCE

5000 MEGOHMS MIN

#### TEMPERATURE RATING

- 55 ~ + 125 °C

MIL-C-50	BRASS
MIL-C-576	COPPER
MIL-G-45204	GOLD PLATING
MIL-T-10727	TIN PLATING