

Side Entry Low Profile S.M.T. Type Jack (Shielded)

3019MS Series

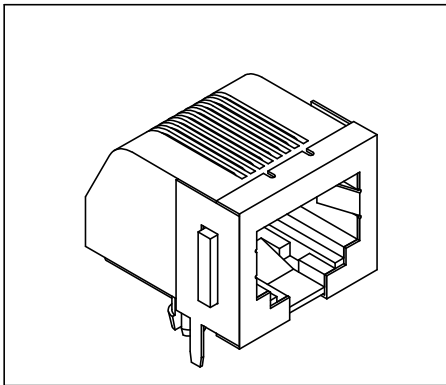

Material and Finish:

- * Housing: Standard Material: Glass Filled Polyester UL94V-0.
Standard Color: Black.
- * Contact: 0.35mm(0.014") Thickness Phosphor Bronze.
Gold Plating over Nickel.
Tin/Lead Plating in Solder Area.
- * Shielded: 0.25mm(0.010") Thickness Copper Alloy
Plated with Tin/Lead.
- * Cavity conforms to FCC rules and regulations part 68,
subpart F.

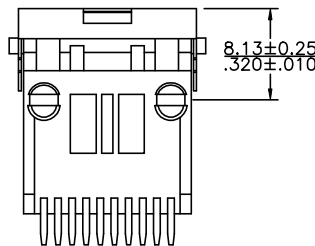
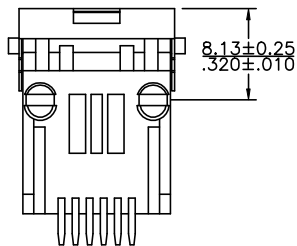
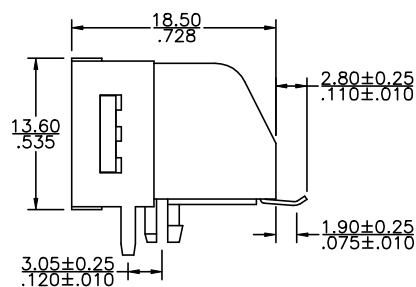
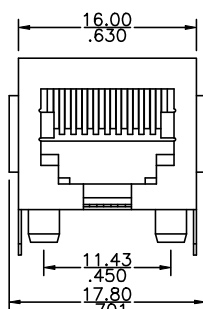
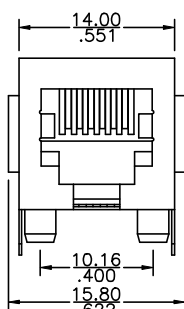

6 Position

8 Position
10 Position

| No. of Positions | Dimension | |
|------------------|---------------|---------------|
| | A | B |
| 6 | 10.16 .400 | 13.72 .540 |
| 8 | 11.43 .450 | 15.43 .607 |
| 10 | 11.43 .450 | 15.43 .607 |

P.C.B. Hole Layout

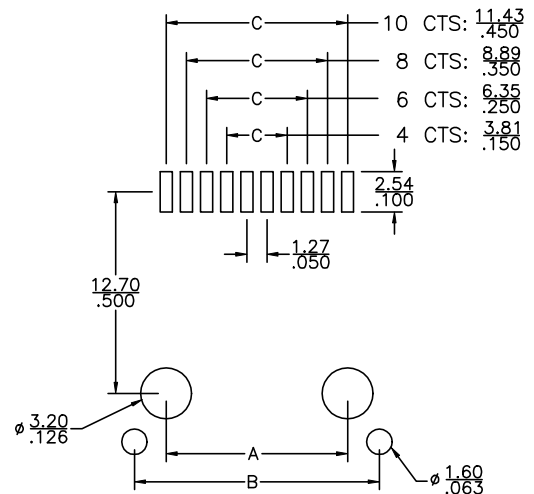

Ordering Information

| Series No. | No. of Position | No. of Contact | Keyed | Contact Plating |
|------------|-----------------|----------------|------------|-----------------|
| 3019MS | 8 | 8 | 2 | 1 |
| | 6 | 2 | with key 1 | 6 μ" 1 |
| | 8 | 4 | w/o key 2 | 15 μ" 2 |
| | 10 | 6 | | 30 μ" 3 |
| | | 8 | | 50 μ" 4 |
| | | 10 | | |

SINGATRON U.S.A. Tel: (909)464-1883 Fax: (909)464-1884 Email: sales@singatron.com