

# 2.54mm (0.1") Pin Header

## 2100 Series

### APPLICATION AND FEATURES

1. Variable pin length, gold or tin plated.
2. Standoffs facilitate post soldering clean.
3. Mate with P.C.Board connectors such as 2221,2222,2223,2225,2226,2227 & 2206 series.

### SPECIFICATIONS

Current Rating: 3 Amps  
 Insulator resistance: 5000 Megohms min.  
 Dielectric withstanding: AC 500 V  
 Operating Temperature: -40° to +105°C  
 Contact Material: Brass  
 Insulator Material: Polyester, UL 94V-0  
 ©Standard: P.B.T

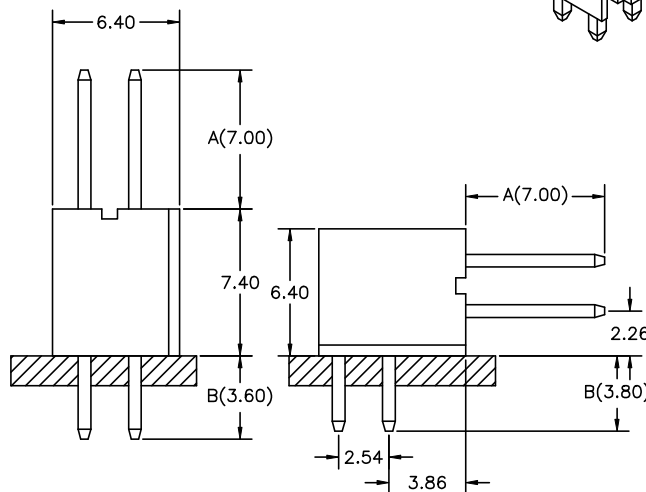
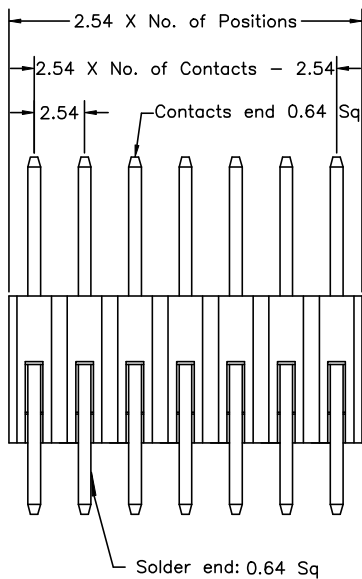
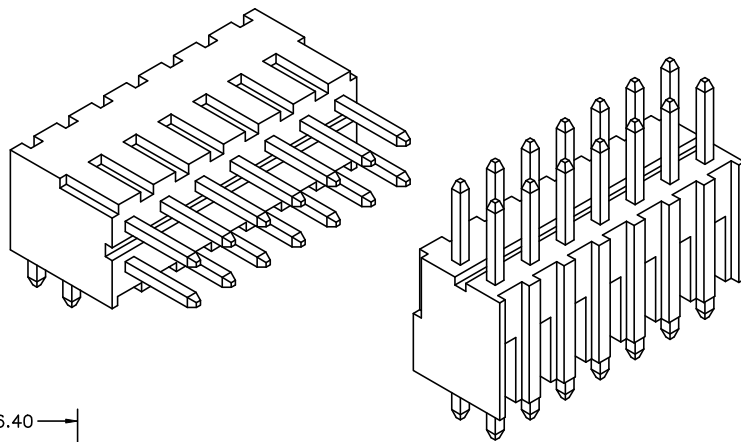

Recommended P.C.Board Hole Layout

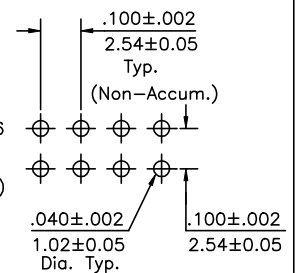

### Order Information 2100 Series

Example: 2100 - 20 - S - 02 - A/B

Series No.	Number of Contacts	Connector Type	Contact Plating	Pin Length mm
2100	08 to 60 Contacts	Straight S	Tin Plated 01	Straight 7.0/3.6
		Right Angle R	Gold Plated Flash 02	Right Angle 7.0/3.8
			10 μ" 10	
			30 μ" 30	